

Abigail

This stunning beauty offers 1,928 total square feet. As one of two end units you will enjoy the open feel that the natural light provides. The dramatic 2 story great room soars, adding to the open feel of the floor plan. A breakfast bar and or an island can be added to the spacious kitchen layout. This home includes an elegant front room master suite, a generous second bedroom and full bath, with the flexibility to add an extended loft or a third bedroom if desired. A guest suite alternative is also available.

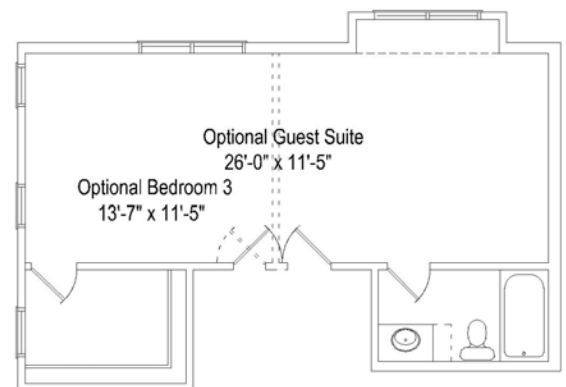
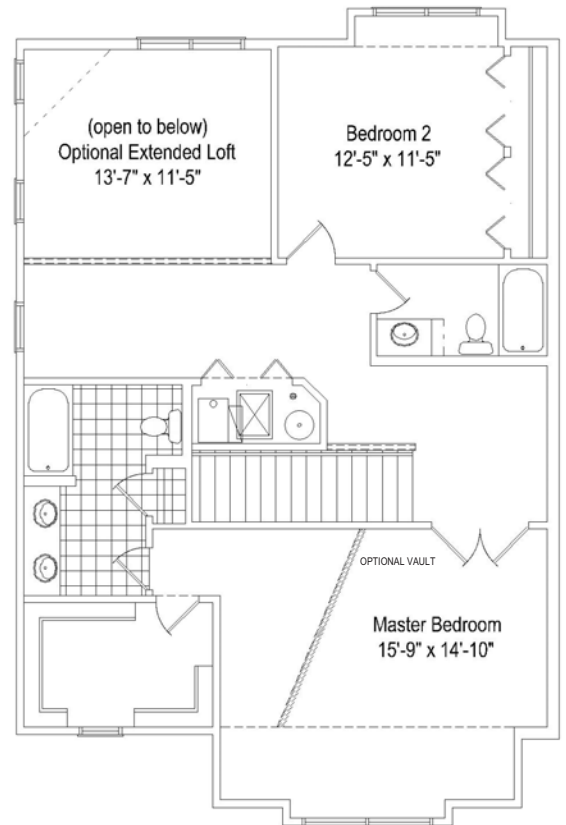
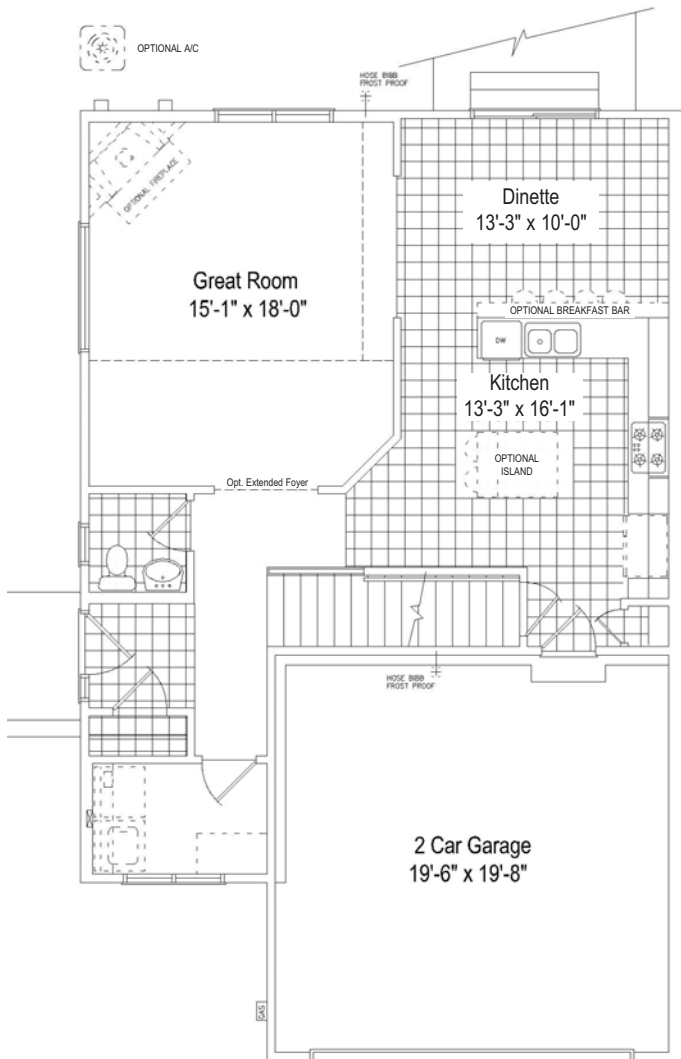

First floor plan reflects a basement condition

- 1,928 square feet
- 2 bedroom 2.5 bath
- Optional guest suite
- Optional 3rd bedroom
- Optional extended loft
- Optional extended loft
- Optional volume ceiling in Master
- Basement available on specific lots

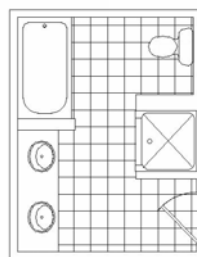

Optional Deluxe Bath



Abigail

Please visit www.gallagher-homes.com for more information on the Style & Value of Gallagher Homes and the Tramore community.

